

RODKICKER



The world's best selling rigid vang

Rodkicker rigid vang

A Seldén Rodkicker facilitates sail handling when reefing, preventing the boom from dropping into the cockpit or onto the coach roof. When fitted with a Seldén gas spring, it lifts the boom when the kicking strap is released. Excellent for trimming the main in light air. The Seldén Rodkicker also doubles the purchase of your kicking strap.

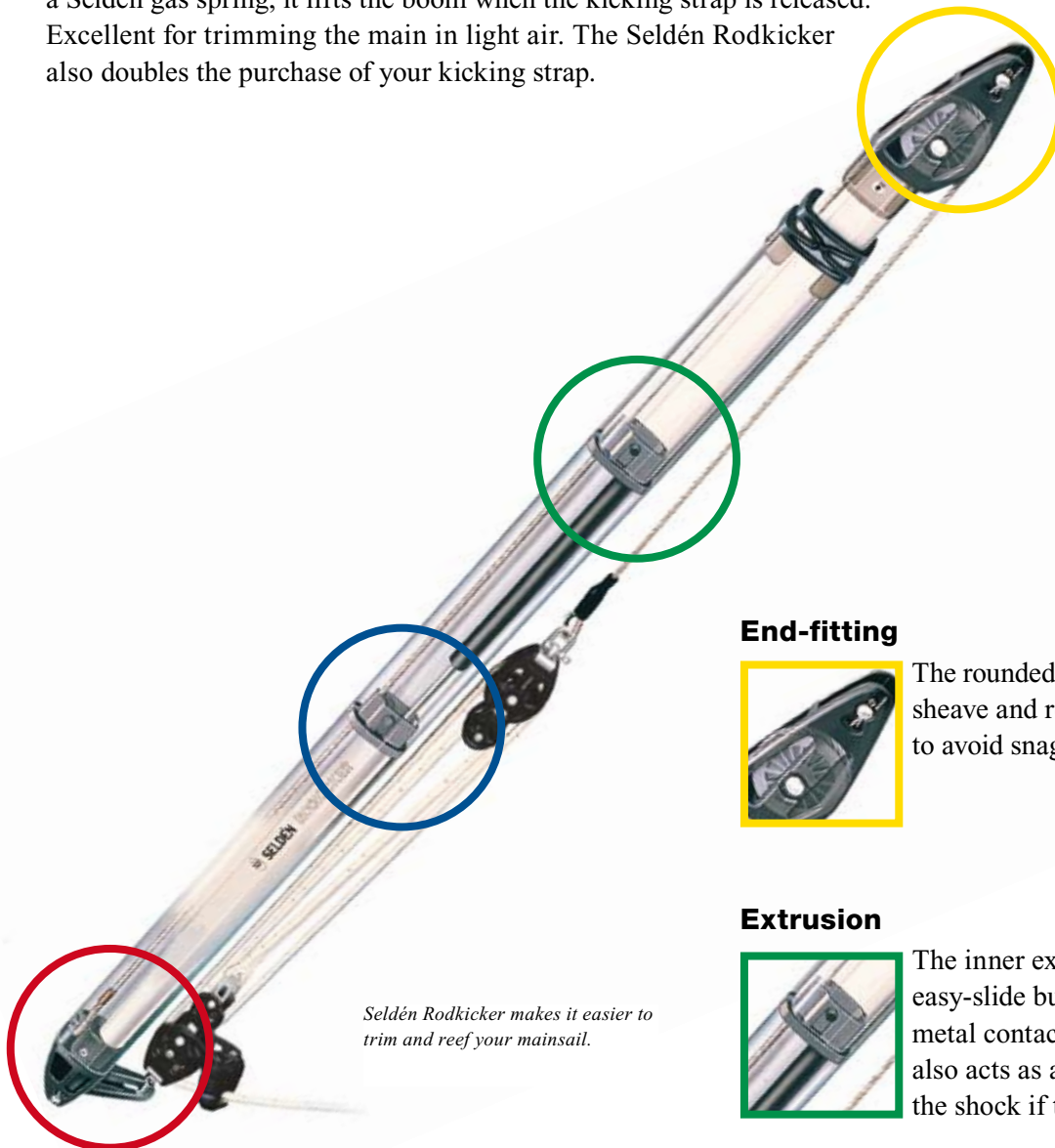

Seldén Rodkicker makes it easier to trim and reef your mainsail.

Easily installed, easily operated



The extended block attachment lug allows the block to turn, enabling the tackle to be operated from either port or starboard. The Rodkicker is supplied with detailed instructions and is easily fitted. If a Rodkicker is retrofitted to an existing rig, the

original kicking strap tackle can still be used. Seldén Rodkickers are made of anodised aluminium and are carefully tested to meet stringent quality and performance standards.

End-fitting



The rounded end-fitting, with enclosed sheave and recessed split pin, is designed to avoid snagging sails or crew.

Extrusion



The inner extrusion end plug acts as an easy-slide bushing and prevents metal to metal contact. The upper sliding bearing also acts as an elastic buffer to dampen the shock if the kicker suddenly bottoms.

Gas spring



The Rodkicker can be supplied with an optional integral gas spring. This lifts the boom when the kicking strap is released, opening the leech of the sail. A Rodkicker with a gas spring replaces the topping lift, making reefing fast and simple. The gas spring is easily retrofitted to a Rodkicker that does not have a spring.

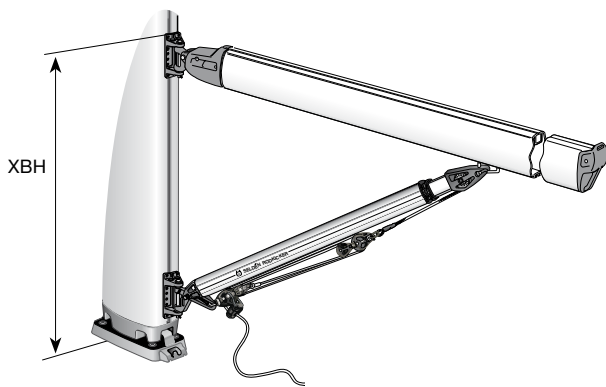

Operation from mast.

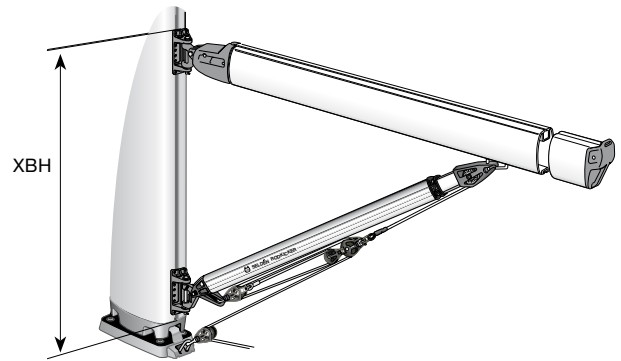



Operation from cockpit.

Choosing the right size

The choice is based mainly on the righting moment of the yacht, a measure of its ability to carry sail. This is approximately proportional to displacement. The second input is the rig type (masthead or fractional). The table below shows the correct type for monohulls.

Gas springs are available in a range of strengths, to cover variations in boom weight (including the stowed sail) and the Rodkicker angle. The angle varies with gooseneck height and kicker length. If in doubt, ask your dealer for more information.

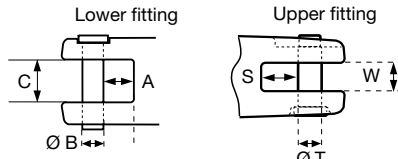
| | | Type 05 | Type 10 | | Type 20 | | Type 30 | | |
|---|-------------------------------------|--|----------------------|--|--------------------------|---|--------------------|---|--|
|  | Max. righting moment: | frac. rig | 12.5 kNm | 25 kNm | 50 kNm | 120 kNm | | | |
| | | masthead rig | 15.0 kNm | 35 kNm | 70 kNm | 160 kNm | | | |
| | Max. displacement: | frac. rig | 2.5 tonnes | 5 tonnes | 9 tonnes | 20 tonnes | | | |
| | | masthead rig | 3.9 tonnes | 6 tonnes | 11 tonnes | 25 tonnes | | | |
| Current Seldén boom section | | B087-B120 | B087-B152 | | B171-B200 | | B200-B250 | | |
| Previous Seldén/ Kemp boom section | | 86/59-111/75 | 86/59-111/75, 128/90 | | 150/105-189/132, 206/139 | | | | |
|  | Height of boom (XBH) | < 900 mm | ≤ 1100 mm | > 1100 mm | ≤ 1400 mm | > 1400 mm | ≤ 1800 mm | > 1800 mm | |
| | Type of Rodkicker | 05 Standard | 10 Standard | 10 Long | 20 Standard | 20 Long | 30 Standard | 30 Long | |
| | Min. length (L) | 1150 mm | 1360 mm | 1670 mm | 1720 mm | 2260 mm | 2200 mm | 2700 mm | |
| | Without gas spring* Art. No. | 058-036-05 | 058-036-10 | 058-036-13 | 076-046-10 | 076-046-13 | 094-056-10 | 094-056-13 | |
| | With gas spring Art. No. | 058-036-06 | 058-036-11 | 058-036-14 | 076-046-11 | 076-046-14 | 094-056-11 | 094-056-14 | |
| | (normal)* Spring force = | 0.7 kN | 0.6 kN | 0.6 kN | 1.2 kN | 1.2 kN | 2.5 kN | 2.5 kN | |
| | With gas spring Art. No. | - | 058-036-12 | 058-036-15 | 076-046-12 | 076-046-15 | 094-056-12 | 094-056-15 | |
| | (hard)* Spring force = | - | 1.2 kN | 1.2 kN | 2.5 kN | 2.5 kN | 5 kN | 5 kN | |
| With gas spring Art. No. | - | 058-036-16 | 058-036-17 | 076-046-16 | 076-046-17 | - | - | | |
| (extra hard)* Spring force = | - | 2.5 kN | 2.5 kN | 5 kN | 5 kN | - | - | | |
| Safe working load | | 8 kN | 12 kN | | 18 kN | | 38 kN | | |
|  | Supplementary Art. No. | 308-038-03 | 308-070-03 | | 308-071-03 | | 308-072-03 | | |
| | kit with normal Spring force = | 0.7 kN | 0.6 kN | | 1.2 kN | | 2.5 kN | | |
| | Supplementary Art. No. | - | 308-071-04 | | 308-072-04 | | 308-073-04 | | |
| kit with hard Spring force = | - | 1.2 kN | | 2.5 kN | | 5 kN | | | |
| Supplementary kit with Art. No. | - | 308-072-05 | | 308-073-05 | | - | | | |
| extra hard spring. Spring force = | - | 2.5 kN | | 5 kN | | - | | | |
|  | Lower fitting | Lower fitting A = 9, Ø B = 10, C = 20 Clevis pin 165-207 | | Lower fitting A = 9, Ø B = 10, C = 20 Clevis pin 165-207 | | Lower fitting A = 11, Ø B = 12, C = 20 Clevis pin 165-404 | | Lower fitting A = 14, Ø B = 16, C = 30 Clevis pin 165-556 | |
| | Upper fitting | Upper fitting S = 7, Ø T = 10, W = 12 Clevis pin 165-205 | | Upper fitting S = 7, Ø T = 10, W = 12 Clevis pin 165-205 | | Upper fitting S = 12, Ø T = 12, W = 14 Clevis pin 165-409 | | Upper fitting S = 11, Ø T = 16, W = 16 Clevis pin 165-555 | |

* Kicking strap tackle not included.

Gas spring, conventional mast

| Boom section | 86/59 | B087 | B104 | B120 | B120 | B135 | 143/76 | B152 | B171 | B200 | B200 | B250 |
|------------------|---|------|------|------|----------------------|-----------------|-----------------|-----------------|----------------------|-----------------|----------------------|---------------|
| Weight, kg/m | 2 | 1.75 | 2.0 | 2.5 | 2.5 | 2.9 | 3.3 | 4.0 | 4.6 | 6 | 6 | 7.5 |
| Circ., mm | 240 | 240 | 300 | 330 | 330 | 370 | 390 | 420 | 460 | 550 | 550 | 680 |
| XBH, mm | Maximum E* normal spring/hard spring/extra hard spring | | | | | | | | | | | |
| Rodkicker | Type 05 | | | | Type 10 (S/L) | | | | Type 20 (S/L) | | Type 30 (S/L) | |
| 600 | 3.4 | 3.6 | 3.4 | 3.1 | 3.0/4.0/5.4 (S) | 2.6/3.6/4.9 (S) | 2.4/3.3/4.6 (S) | | | | | |
| 700 | 3.7 | 3.8 | 3.7 | 3.4 | 3.3/4.4/- (S) | 2.8/3.9/5.3 (S) | 2.7/3.6/5.0 (S) | | | | | |
| 800 | 3.9 | 4.0 | 3.8 | 3.6 | 3.4/4.6/- (S) | 3.0/4.2/5.7 (S) | 2.9/3.6/5.4 (S) | 2.7/3.7/5.1 (S) | 3.4/4.7/- (S) | | | |
| 900 | 4.0 | 4.1 | 4.0 | 3.8 | 3.6/4.8/- (S) | 3.2/4.4/- (S) | 3.1/4.1/5.7 (S) | 2.9/3.9/5.3 (S) | 3.6/5.1/- (S) | -/4.4/6.0 (S) | 4.4/5.9 (S)** | 3.9/5.4 (S)** |
| 1000 | | | | | 3.7/5.0/- (S) | 3.4/4.5/- (S) | 3.2/4.3/5.9 (S) | 3.0/4.1/5.5 (S) | 3.8/5.3/- (S) | 3.3/4.7/6.3 (S) | 4.7/6.3 (S)** | 4.2/5.8 (S)** |
| 1100 | | | | | 3.9/5.2/- (S) | 3.5/4.7/- (S) | 3.4/4.6/6.2 (S) | 3.1/4.3/5.9 (S) | 4.0/5.5/- (S) | 3.5/4.9/6.6 (S) | 5.0/6.7 (S)** | 4.5/6.1 (S) |
| 1200 | | | | | 4.0/5.4/- (L) | 3.7/4.9/- (L) | 3.5/4.7/6.4 (L) | 3.2/4.4/6.0 (L) | 4.2/5.7/- (S) | 3.7/5.2/6.9 (S) | 5.2/7.0 (S) | 4.7/6.4 (S) |
| 1300 | | | | | 4.2/- (L) | 3.7/5.0/- (L) | 3.6/4.8/6.5 (L) | 3.3/4.5/6.2 (L) | 4.3/5.8/- (S) | 3.8/5.3/7.1 (S) | 5.4/7.2 (S) | 4.9/6.6 (S) |
| 1400 | | | | | | | 3.6/4.9/6.6 (L) | 3.4/4.6/6.3 (L) | 4.4/6.0/- (S) | 3.9/5.4/7.3 (S) | 5.6/7.4 (S) | 5.0/6.8 (S) |
| 1500 | | | | | | | | | 4.6/6.3/- (L) | 4.0/5.5/7.4 (S) | 5.7/7.7 (S) | 5.2/7.0 (S) |
| 1600 | | | | | | | | | 4.7/6.4/- (L) | 4.3/5.9/7.9 (L) | 5.9/7.8 (S) | 5.3/7.2 (S) |
| 1700 | | | | | | | | | | 4.3/6.0/8.0 (L) | 6.0/8.0 (S) | 5.4/7.4 (S) |
| 1800 | | | | | | | | | | | 6.2/8.3 (L) | 5.5/7.5 (L) |
| 1900 | | | | | | | | | | | | 5.8/7.8 (L) |
| 2000 | | | | | | | | | | | | 5.9/8.0 (L) |



Rodkicker Type 05.

Gas spring, furling mast

| Boom section | B120 | B120 | B135 | 143/76 | B152 | B171 | B200 | B200 | B250 |
|------------------|---|----------------------|---------------|-----------------|-----------------|----------------------|-----------------|----------------------|---------------|
| Weight, kg/m | 2.5 | 2.5 | 2.9 | 3.3 | 4 | 4.6 | 6 | 6 | 7.5 |
| Circ., mm | 330 | 330 | 370 | 390 | 420 | 460 | 550 | 550 | 680 |
| XBH, mm | Maximum E* normal spring/hard spring/extra hard spring | | | | | | | | |
| Rodkicker | Type 05 | Type 10 (S/L) | | | | Type 20 (S/L) | | Type 30 (S/L) | |
| 600 | 3.5 | 3.3/4.5/- (S) | 2.8/4.0/- (S) | 2.3/3.4/5.0 (S) | | | | | |
| 700 | 4.0 | 3.7/5.4/- (S) | 3.2/4.5/- (S) | 2.7/3.9/5.7 (S) | 2.5/3.6/5.3 (S) | | | | |
| 800 | 4.3 | 4.0/5.8/- (S) | 3.5/5.0/- (S) | 3.0/4.3/6.4 (S) | 2.8/4.0/5.8 (S) | 3.6/5.2/- (S) | | | |
| 900 | | 4.3/5.9/- (S) | 3.7/5.3/- (S) | 3.3/4.7/6.9 (S) | 3.0/4.4/6.3 (S) | 3.9/5.7/- (S) | -/4.6/6.6 (S) | 4.4/6.3 (S)** | 3.8/5.4 (S)** |
| 1000 | | 4.5/- (S) | 3.9/5.5/- (S) | 3.5/5.0/- (S) | 3.2/4.7/- (S) | 4.2/6.2/- (S) | -/5.1/7.3 (S) | 4.9/7.0 (S)*** | 4.2/6.0 (S) |
| 1100 | | 4.7/- (S) | 4.1/5.9/- (S) | 3.7/5.4/- (S) | 3.4/4.9/- (S) | 4.5/6.6/- (S) | -/5.5/7.9 (S) | 5.4/7.6 (S) | 4.6/6.6 (S) |
| 1200 | | 5.0/- (L) | 4.2/- (L) | 3.9/5.6/- (L) | 3.6/5.2/- (L) | 4.7/6.8/- (S) | 3.9/5.8/8.4 (S) | 5.8/8.2 (S) | 4.9/7.1 (S) |
| 1300 | | 5.2/- (L) | 4.3/- (L) | 4.0/5.8/- (L) | 3.7/5.3/- (L) | 4.9/7.1/- (S) | 4.1/6.1/8.7 (S) | 6.1/8.7 (S) | 5.2/7.5 (S) |
| 1400 | | | | 4.1/5.9/- (L) | 3.8/5.4/- (L) | 5.0/7.3/- (S) | 4.3/6.3/9.0 (S) | 6.4/9.2 (S) | 5.5/7.9 (S) |
| 1500 | | | | | | 5.3/- (L) | 4.4/5.6/9.3 (S) | 6.7/- (S) | 5.8/8.2 (S) |
| 1600 | | | | | | 5.4/- (L) | 4.7/6.9/- (L) | 6.9/- (S) | 5.9/8.5 (S) |
| 1700 | | | | | | | 4.9/7.1/- (L) | 7.1/- (S) | 6.2/8.8 (S) |
| 1800 | | | | | | | | 7.4/- (S) | 6.3/9.0 (S) |
| 1900 | | | | | | | | 7.6/- (L) | 6.6/9.4 (L) |
| 2000 | | | | | | | | | 6.7/9.6 (L) |

S = Standard L = Long Circ. = Circumference XBH: See page 87.

* The maximum E (sail foot length) lists extend beyond the Seldén boom range, to allow selection of the correct Rodkicker for other booms.

** An extra hard spring is available. Please contact your Seldén dealer. *** Boom slider 511-599-01 required.

SELDÉN and FURLEX are registered trademarks of Seldén Mast AB

Seldén Mast AB, Sweden Tel +46 (0)31 69 69 00. Fax +46 (0)31 29 71 37. e-mail info@seldenmast.com

Seldén Mast Limited, UK Tel +44 (0)1329 50 40 00. Fax +44 (0)1329 50 40 49. e-mail info@seldenmast.co.uk

Seldén Mast Inc., USA Tel +1 843-760-6278. Fax +1 843-760-1220. e-mail info@seldenus.com

Seldén Mast A/S, Denmark Tel +45 39 18 44 00. Fax +45 39 27 17 00. e-mail info@seldenmast.dk

Seldén Mid Europe B.V., Netherlands Tel +31 (0) 111-698 120. Fax +31 (0) 111-698 130. e-mail info@seldenmast.nl

Seldén Mast, France Tel +33 (0) 251 362 110. Fax +33 (0) 251 362 185. e-mail info@seldenmast.fr

www.seldenmast.com

 **SELDÉN**
for sailing